

TEC \ AUTOMATISMES

50<sup>ANS</sup>  
DANS L'ÉLECTROMÉCANIQUE

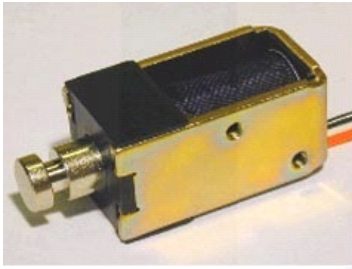



**TEC**

7B07X

Alimentation : 6 to 24 VDC

### Autres modèles

7B07X  
7B08T  
7B10T

### ► Description

**LINEAR MONOSTABLE SOLENOID WITH MAGNETIC LOCKING BY PERMANENT MAGNET**

**POWER REQUIREMENTS** : Direct current : 20 W

HOLD FORCE thanks to the permanent magnet : 0,48 daN with power supply at nominal voltage.  
: Direct current : 20 W : 0,48 daN with power supply at nominal voltage.

### ► Performances

• COURANT CONTINU

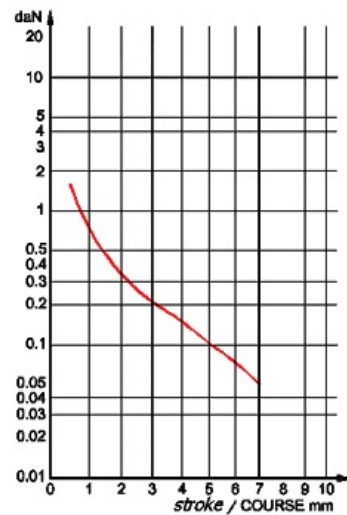

— duty cycle intermittent service nominal voltage cold coil

### ► Plan d'encombrement / dimensions

• COURANT CONTINU

7B07X - front view

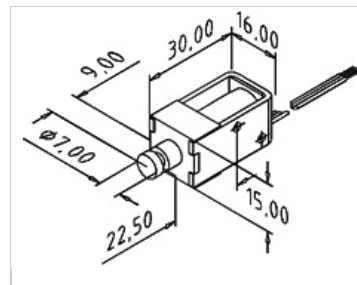

7B07X - back view

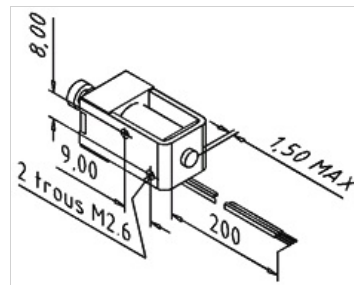

**Document non-contractuel** - Caractéristiques à se faire confirmer avant commande  
Tec automatismes se réserve le droit de modifier les descriptions et spécifications sans préavis